

LASERVET 15.0

LASER THERAPY

LASERVET 15.0 IS A PORTABLE DEVICE FOR HIGH PULSED POWER LASER THERAPY THAT ALLOWS TO PERFORM VETERINARY TREATMENTS IN QUICK TIMES. THE DISEASES TREATED ARE DIVIDED BY ANIMAL, WITH PARTICULAR ATTENTION TO EQUINES. THE ACTION OF LASER IS AIMED AT TISSUE REGENERATION, POST-TRAUMATIC AND ANTI-INFLAMMATORY TREATMENT AND REDUCTION OF BOTH CHRONIC AND ACUTE PAIN.

SPECIFIC PROGRAMS FOR DOGS, CATS, HORSES, SMALL MAMMALS, REPTILES AND BIRDS

TECHNICAL FEATURES

Display

Backlit, 2.6"

Laser source

Class 4 GaAlAs diode

Peak power

15W \pm 20%

Preset for wave length

808nm

980nm and 1064nm (optional)

Issue

Pulsed and continuous

Target area dimensions

11 mm and 30 mm optics

60 mm optics (optional)

Frequency

Up to 10000Hz

Power supply

Mains and rechargeable battery

Size and weight

220x170x60 mm - 790 gr

STANDARD EQUIPMENT

- 1 Carrying case
- 1 LASERVET 15.0 device
- 1 Laser handpiece 808nm with 11 mm and 30 mm optics
- 2 Protection glasses
- 1 Power supply unit
- 1 Operating manual

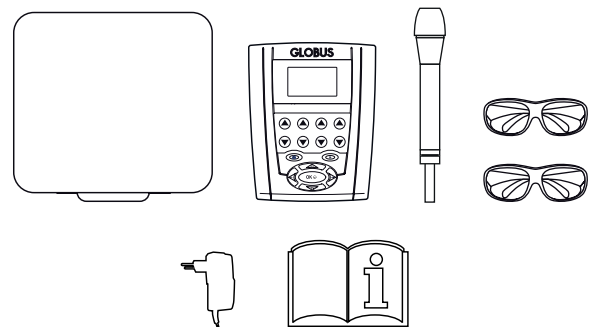

PURCHASE OPTIONS

- Code G5995 HP Handpiece 980nm power 15W
- Cod. G5996 Handpiece 1064nm power 3W
- Cod. G6089 Optics da 60 mm



- LAST 10
- MULTI USER
- PROGRAMMABLE
- RENTAL OPTION
- BATTERY PACK
- MAINS POWER SUPPLY

LASERVET 15.0

LASER THERAPY

MORE THAN 130 PROGRAMS FOR DOGS, CATS, HORSES, SMALL MAMMALS, REPTILES AND BIRDS. TREATMENTS INCLUDE PROTOCOLS FOR:

Muscle-skeletal injuries such as arthrosis, tendinopathies, contusions, bursitis, sprains, muscle strains, fractures, dysplasia, neuropathies etc.

Pathologies of the integumentary system such as skin wounds, granulomas, sacculitis, perianal fistulas, pododermatitis, abrasions, etc.

Pathologies of other systems such as otitis, sinusitis, stomatitis etc.

